

SECTIONS

IN PARLIAMENT - SESSION 2006 - 07
 CROSSRAIL
 (AMENDMENT OF PROVISIONS - MAY 2007)
 Works Nos. 1/6A & 1/6B (Railways)

WORK No. 1/6A

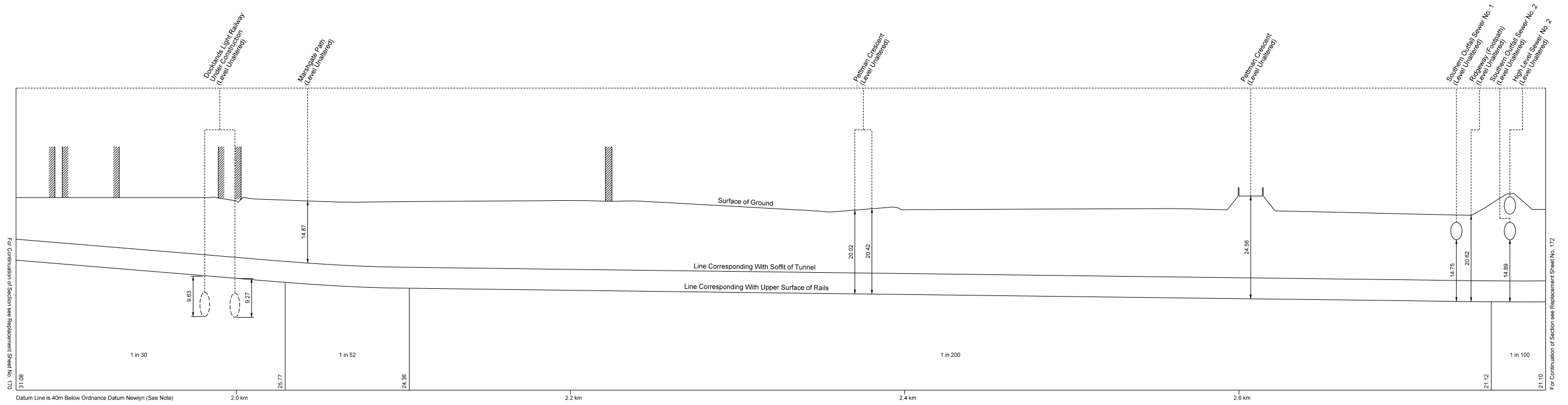

WORK No. 1/6B

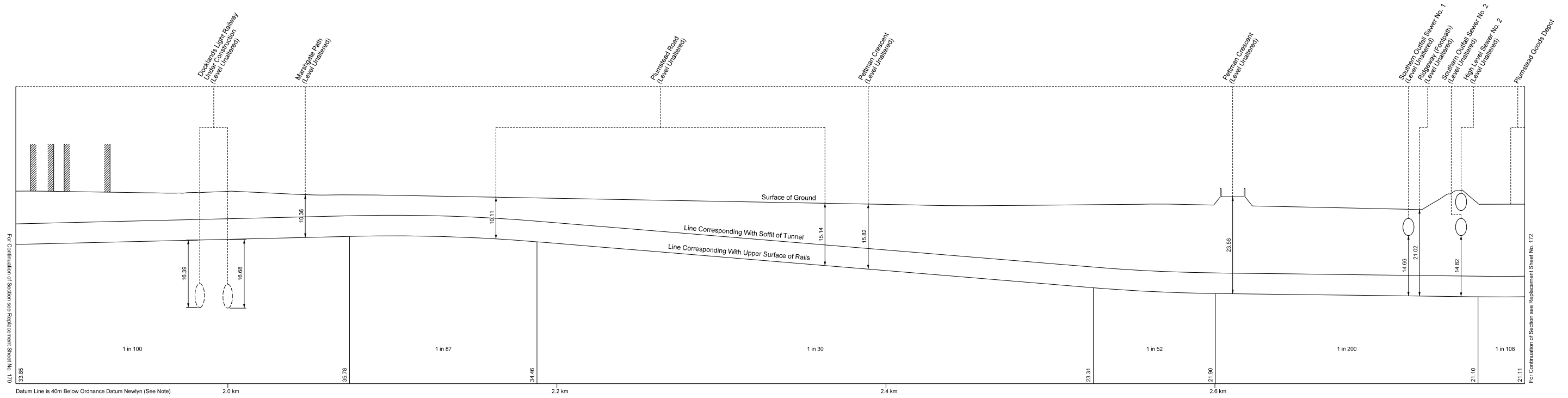

Adjustments to this Sheet are as follows:
 Works Nos. 1/6A & 1/6B realigned.

Drawing No. I10408-C1G00-F00-F-50171 Rev E