

GREATER LONDON

IN PARLIAMENT - SESSION 2004-05

CROSSRAIL

Works Nos. 2/13 & 2/13A (Railways)
For Section of Work No. 2/13 see Sheet No. 209
For Section of Work No. 2/13A see Sheet No. 210

PLAN

LONDON BOROUGH OF BARKING & DAGENHAM

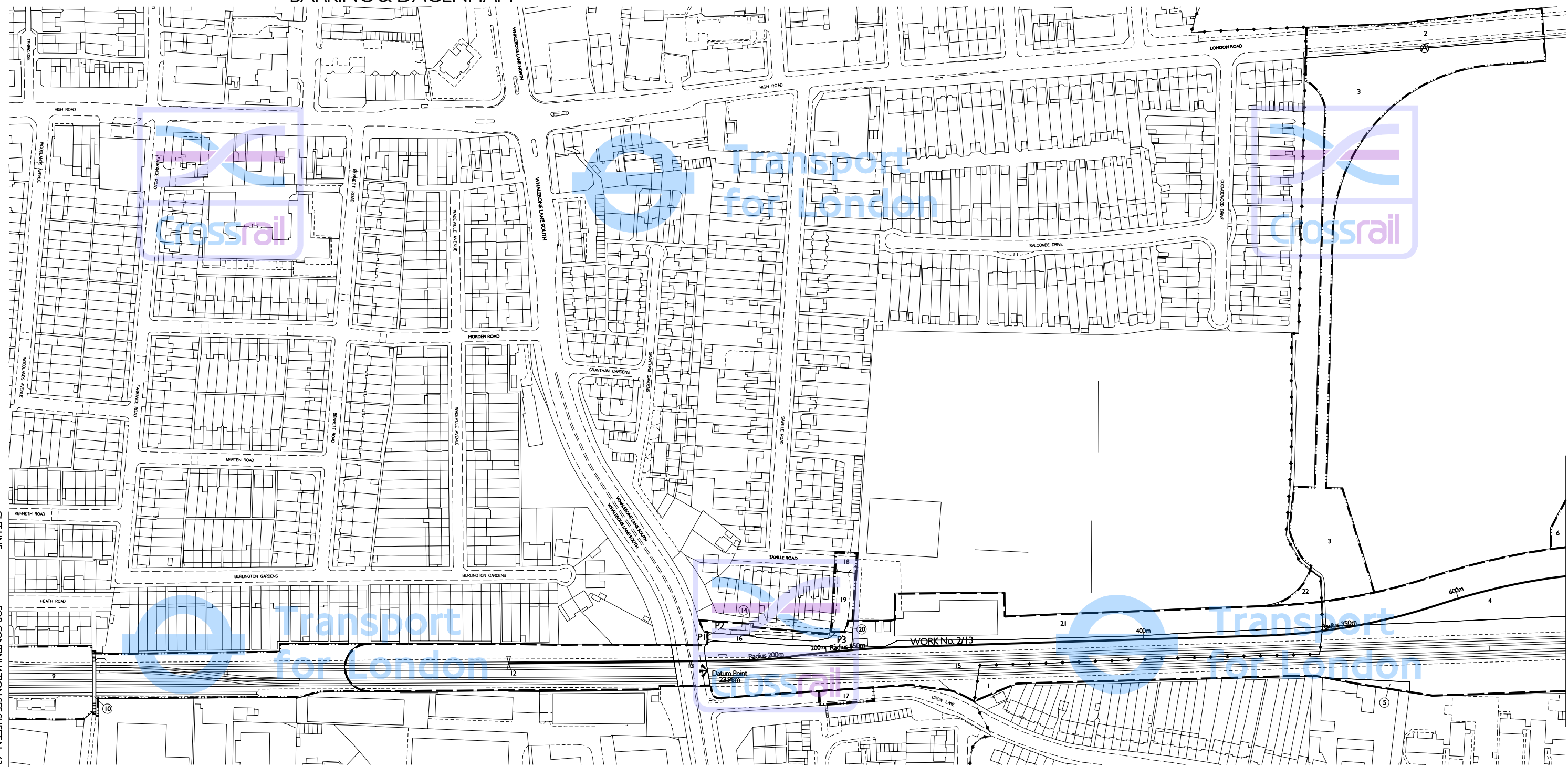

LONDON BOROUGH OF HAVERING

THIS MAP IS BASED UPON ORDNANCE SURVEY MATERIAL WITH THE PERMISSION OF ORDNANCE SURVEY ON BEHALF OF THE CONTROLLER OF HER MAJESTY'S STATIONERY OFFICE © CROWN COPYRIGHT. UNAUTHORISED REPRODUCTION INFRINGES CROWN COPYRIGHT AND MAY LEAD TO PROSECUTION OR CIVIL PROCEEDINGS. (GLA - 100032379) (2005).



The area enclosed by any limit of deviation or by any limit of land to be acquired or used is the area extending to the outer edge of the line marking those limits.

For key to symbols and line styles see Index Sheet

Scale is 1:1,250 at A1 size

Drawing No. 110401-E1G00-F00-F-50215 Rev J