

SECTIONS

IN PARLIAMENT - SESSION 2005 - 06

CROSSRAIL
(AMENDMENT OF PROVISIONS - MAY 2006)

Works Nos. 1/21A, 1/23A, 1/23B, 1/24 & 1/26C (Sewers),
Works Nos. 1/22, 1/26A & 1/26B (Subways)

May 2006 - Adjustments to this Sheet are as follows; Work No. 1/21 (Sewer) deleted. Work No. 1/21A (Sewer) added.
January 2006 - Adjustments to this Sheet are as follows; Work No. 1/26A revision to junction with Work No. 1/26B Work No. 1/26B revision to escalator alignment

WORK No. 1/21A

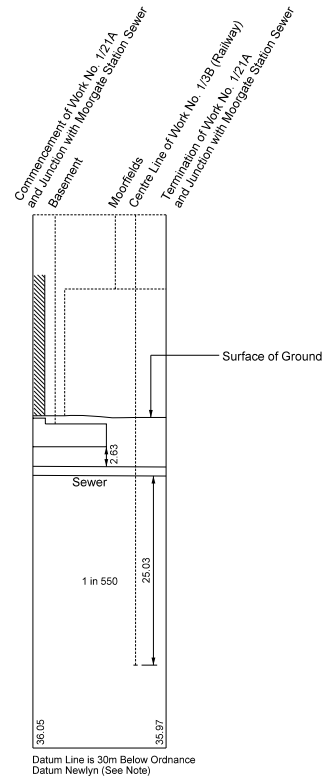

The Datum Line for Work No. 1/21 is 43.25 metres below Ordnance Survey Bench Mark (13.25 metres above Ordnance Datum Newlyn) cut thus ∇ on the north east corner of 81, Coleman Street and marked thus ∇ on plan Replacement Sheet No. 15.

WORK No. 1/22

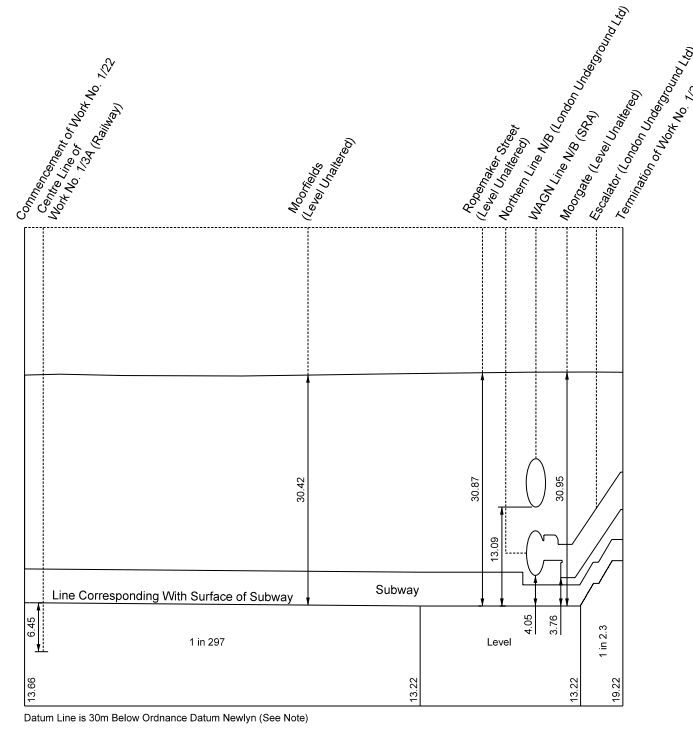

The Datum Line for Work No. 1/22 is 43.25 metres below Ordnance Survey Bench Mark (13.25 metres above Ordnance Datum Newlyn) cut thus ∇ on the north east corner of 81, Coleman Street and marked thus ∇ on plan Replacement Sheet No. 15.

WORK No. 1/23A

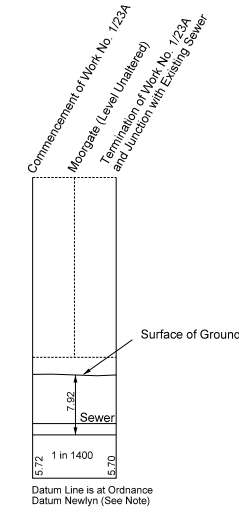

The Datum Line for Work No. 1/23A is 13.25 metres below Ordnance Survey Bench Mark (13.25 metres above Ordnance Datum Newlyn) cut thus ∇ on the north east corner of 81, Coleman Street and marked thus ∇ on plan Replacement Sheet No. 15.

WORK No. 1/23B

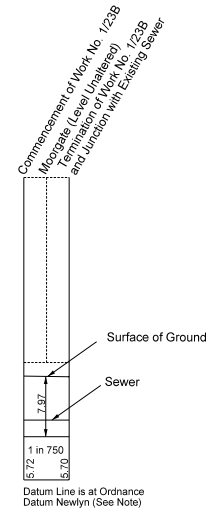

The Datum Line for Work No. 1/23B is 13.25 metres below Ordnance Survey Bench Mark (13.25 metres above Ordnance Datum Newlyn) cut thus ∇ on the north east corner of 81, Coleman Street and marked thus ∇ on plan Replacement Sheet No. 15.

WORK No. 1/26A

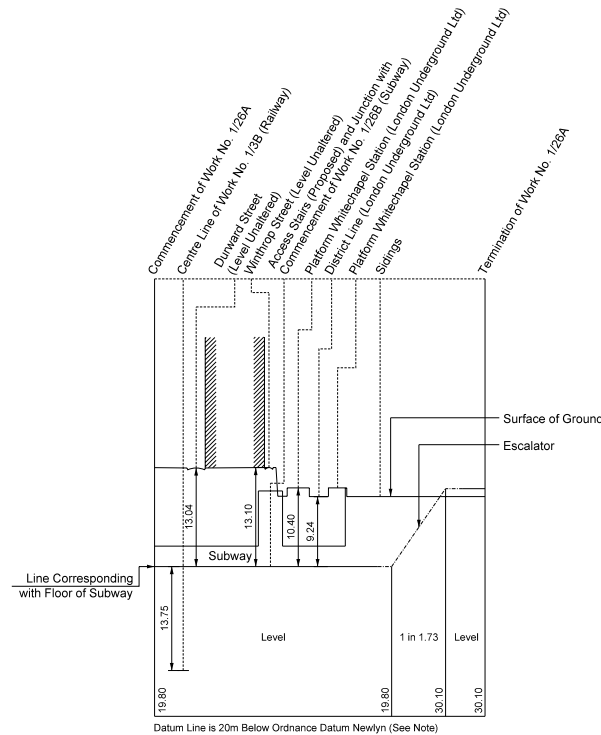

The Datum Line for Work No. 1/26A is 33.22 metres below Ordnance Survey Bench Mark (13.22 metres above Ordnance Datum Newlyn) cut thus ∇ on the north west face of The London Hospital, in Whitechapel Avenue and marked thus ∇ on plan Replacement Sheet No. 17.

WORK No. 1/26B

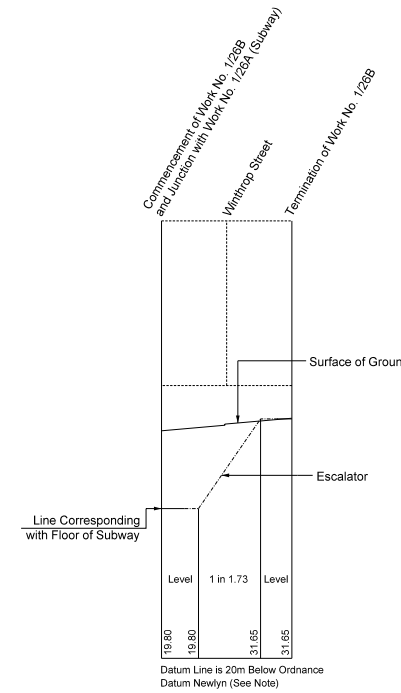

The Datum Line for Work No. 1/26B is 33.22 metres below Ordnance Survey Bench Mark (13.22 metres above Ordnance Datum Newlyn) cut thus ∇ on the north west face of The London Hospital, in Whitechapel Avenue and marked thus ∇ on plan Replacement Sheet No. 17.

WORK No. 1/26C

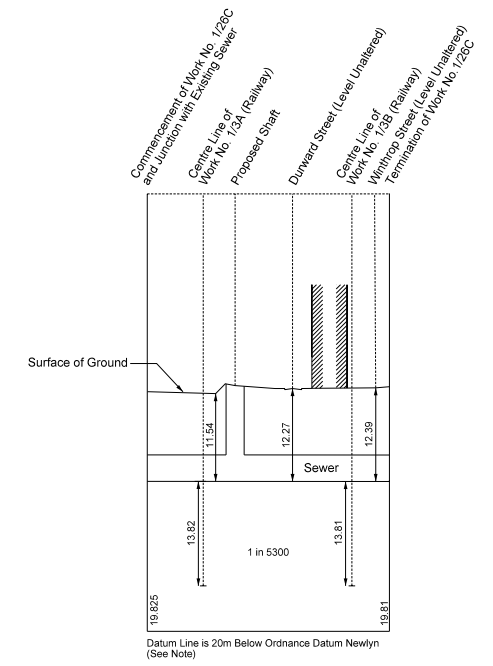

The Datum Line for Work No. 1/26C is 33.22 metres below Ordnance Survey Bench Mark (13.22 metres above Ordnance Datum Newlyn) cut thus ∇ on the north west face of The London Hospital, in Whitechapel Avenue and marked thus ∇ on plan Replacement Sheet No. 17.

WORK No. 1/24

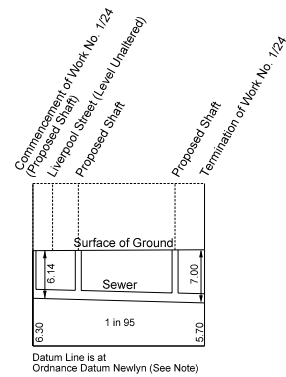

The Datum Line for Work No. 1/24 is 13.82 metres below Ordnance Survey Bench Mark (13.82 metres above Ordnance Datum Newlyn) cut thus ∇ on the south face of 83, London Wall and marked thus ∇ on plan Replacement Sheet No. 15.

