

SECTIONS

IN PARLIAMENT - SESSION 2004 - 05

CROSSRAIL

Works Nos. 2/14A, 2/14B, 2/15D & 2/15E (Roads)
 Work No. 2/15A (Sewer),
 Work No. 2/15B (Bridge Widening)
 Work No. 2/15C (Bridge)

WORK No. 2/14A

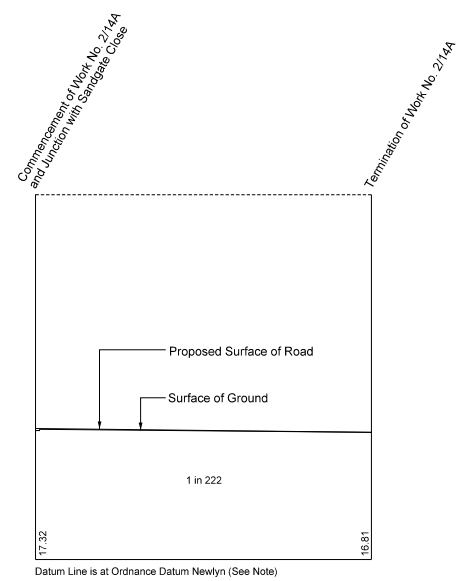

Datum Line is at Ordnance Datum Newlyn (See Note)

Greatest Inclination of Proposed Road 1 in 222

The Datum Line for Work No. 2/14A is 16.76 metres below Ordnance Survey Bench Mark (16.76 metres above Ordnance Datum Newlyn) cut thus ∇ on the south east face of 68, Coteigh Road and marked thus ∇ on plan Sheet No. 66.

WORK No. 2/14B

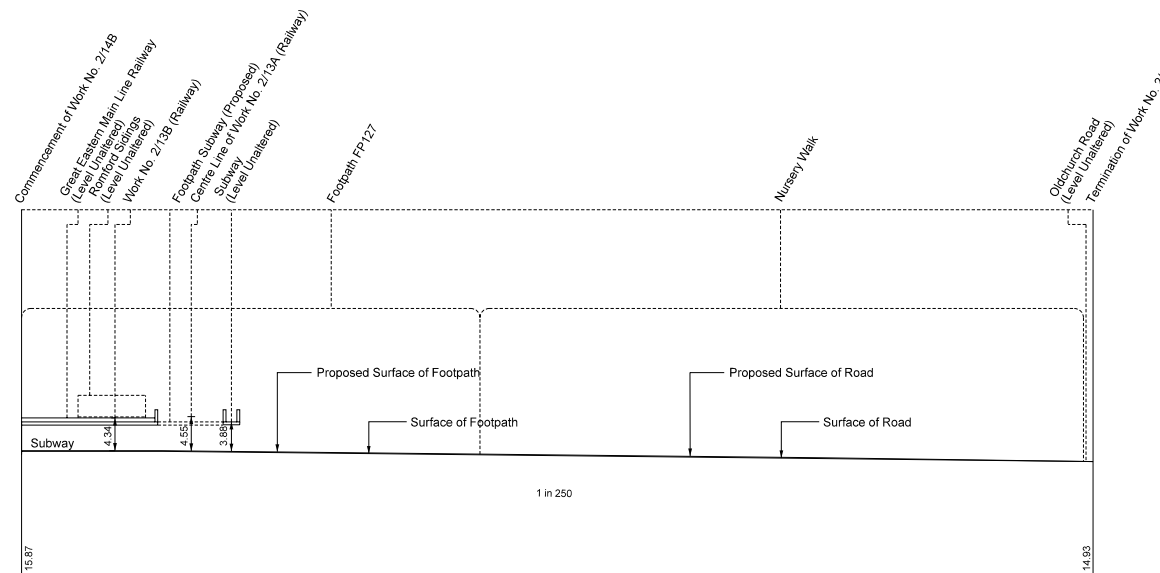

Datum Line is at Ordnance Datum Newlyn (See Note)

Greatest Inclination of Existing Road 1 in 250
 Greatest Inclination of Road When Altered 1 in 250

The Datum Line for Work No. 2/14B is 16.76 metres below Ordnance Survey Bench Mark (16.76 metres above Ordnance Datum Newlyn) cut thus ∇ on the south east face of 68, Coteigh Road and marked thus ∇ on plan Sheet No. 66.

WORK No. 2/15A

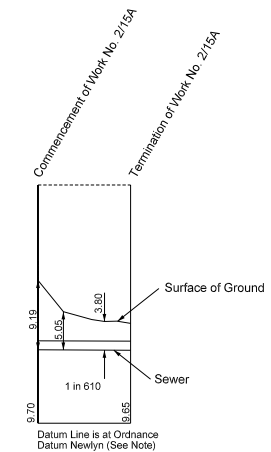

Datum Line is at Ordnance Datum Newlyn (See Note)

The Datum Line for Work No. 2/15A is 16.03 metres below Ordnance Survey Bench Mark (16.03 metres above Ordnance Datum Newlyn) cut thus ∇ on the south east corner of south face flats 10-24, Waterloo Road and marked thus ∇ on plan Sheet No. 67.

WORK No. 2/15B

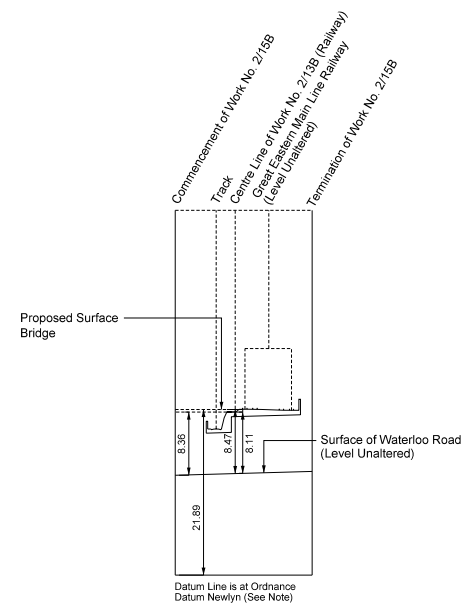

Datum Line is at Ordnance Datum Newlyn (See Note)

The Datum Line for Work No. 2/15B is 16.03 metres below Ordnance Survey Bench Mark (16.03 metres above Ordnance Datum Newlyn) cut thus ∇ on the south east corner of south face flats 10-24, Waterloo Road and marked thus ∇ on plan Sheet No. 67.

WORK No. 2/15C

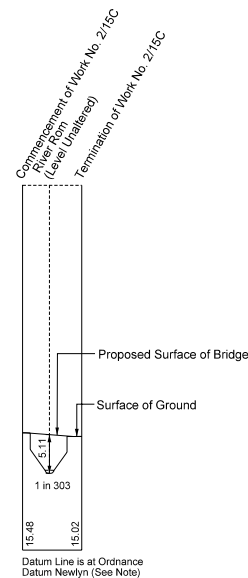

Datum Line is at Ordnance Datum Newlyn (See Note)

The Datum Line for Work No. 2/15C is 16.03 metres below Ordnance Survey Bench Mark (16.03 metres above Ordnance Datum Newlyn) cut thus ∇ on the south east corner of south face flats 10-24, Waterloo Road and marked thus ∇ on plan Sheet No. 67.

WORK No. 2/15D

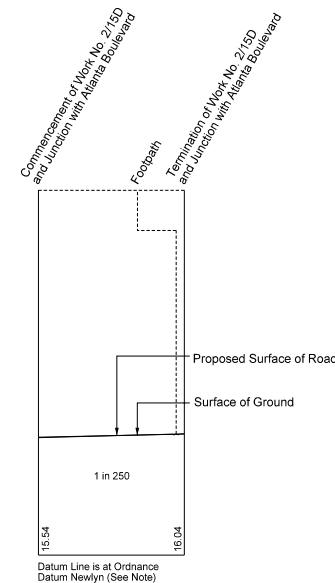

Datum Line is at Ordnance Datum Newlyn (See Note)

Greatest Inclination of Proposed Road 1 in 250

The Datum Line for Work No. 2/15D is 15.58 metres below Ordnance Survey Bench Mark (15.58 metres above Ordnance Datum Newlyn) cut thus ∇ on the east face of Romford Station Building and marked thus ∇ on plan Sheet No. 67.

WORK No. 2/15E

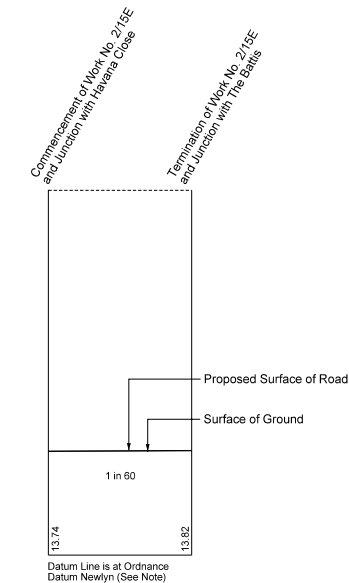

Datum Line is at Ordnance Datum Newlyn (See Note)

Greatest Inclination of Proposed Road 1 in 60

The Datum Line for Work No. 2/15E is 15.58 metres below Ordnance Survey Bench Mark (15.58 metres above Ordnance Datum Newlyn) cut thus ∇ on the east face of Romford Station Building and marked thus ∇ on plan Sheet No. 67.

